

P/N	INTERFACE	FIGURE
-1SF	FULL DETENT	1
-2SF	LIMITED DETENT	1
-3SF	SMOOTH BORE	1
-4SF	CATCHERS MITT	2

REVISIONS			
REV	DESCRIPTION	DATE	BY
D	ECO 11728	06/27/00	IMG
E	ECO 26075 (CHG DWG FORMAT)	08.14.12	DKN
F	ECO 202352 (ADD NEW NAME)	11.25.24	DKN

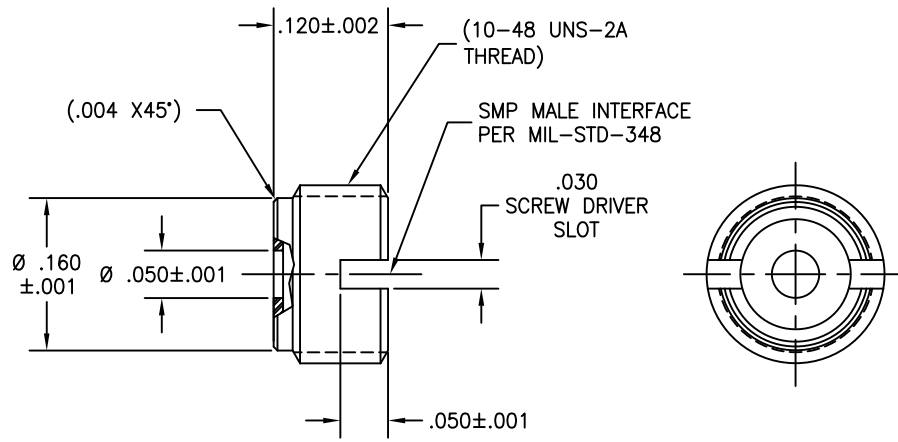

FIGURE 1

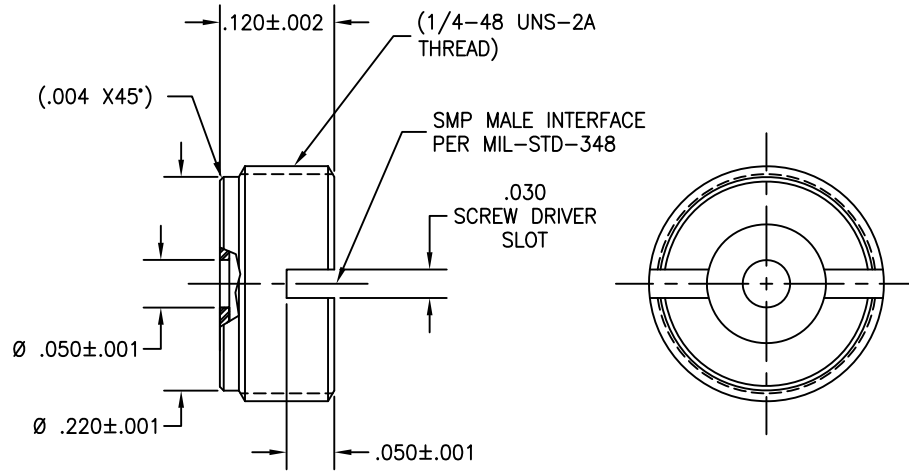

FIGURE 2

MATERIAL:	MECHANICAL:	ENVIRONMENTAL:
Body: 303 sst per ASTM A-582.	Mating Characteristics: Interface per Mil-Std-348. Force To Engage & Disengage: Engage: Full detent: 15.0 lbs max Limited detent: 10.0 max Smooth bore/Catchers mitt: 2.0 lbs max Disengage: Full detent: 5.0 lbs min Limited detent: 2.0 lbs min Smooth bore/Catchers mitt: .50 lbs min Connector Durability: Depend on detent	Temperature Range: -65°C to +165°C. Thermal Shock: Mil-Std-202, Method 107, Test Cond. B. Moisture Resistance: Mil-Std-202, Method 106, except step 7b shall be omitted. Corrosion: Mil-Std-202, Method 101, Test Cond. B. Vibration: Mil-Std-202, Method 204, Test Cond. D. Shock: Mil-Std-202, Method 213, Test Cond. I.

FINISH: Body: Passivate per ASTM A-967, Nitric 1.	APPLICABLE Amphenol CDI DOCUMENTS <table border="1"> <thead> <tr> <th>WORK STD</th> <th>PROD INST</th> <th>ASSY INST</th> </tr> </thead> <tbody> <tr> <td>NA</td> <td>NA</td> <td>NA</td> </tr> </tbody> </table>	WORK STD	PROD INST	ASSY INST	NA	NA	NA	TOLERANCES AND NOTES EXCEPT AS NOTED INTERPRET DRAWING PER ASME Y14.5-2018 DIMENSIONS ARE IN INCHES: LINEAR .001 ±.015 ANGULAR ± 1/2° FRACTION ± 1/32 1. MACHINING FINISH: ES/ RMS 2. BREAK ALL SHARP EDGES .003 MAX. 3. MACHINING FILLETS .005 MAX. 4. MACHINED SURFACES SQUARE TO RESPECTIVE AXES WITHIN .005 INCHES PER INCH. 5. MACHINED DIAMETERS CONCENTRIC WITHIN .002 T.I.R. 6. DIMENSIONS TO BE MET BEFORE PLATING. 7. CHAMFER ALL THREADS 40°. 8. THREADS PER 10-25. 9. REMOVE FRAVED EDGES ON TEFLON. 10. REMOVE ALL BURRS.	<table border="1"> <thead> <tr> <th colspan="2">MATERIAL</th> <th colspan="2">SPECIFICATION</th> <th colspan="2">PROCUREMENT</th> </tr> </thead> <tbody> <tr> <td>APPROVAL INITIALS</td> <td>DATE</td> <td colspan="2" rowspan="4"> Amphenol CDI 12900 Alondra Blvd. Cerritos, CA 90703 </td> <td colspan="2" rowspan="4"> SHEET 1 OF 1 </td> </tr> <tr> <td>DRAWN BY</td> <td>BRD 02/16/96</td> </tr> <tr> <td>CHECKED BY</td> <td></td> </tr> <tr> <td>TEST ENGG</td> <td></td> </tr> <tr> <td>QUALITY</td> <td></td> <td colspan="2">TITLE</td> <td colspan="2">SMP SHROUD, THREAD IN STYLE</td> </tr> <tr> <td>DESIGN ENGG</td> <td>ATV 07.05.00</td> <td>SCALE</td> <td>10/1</td> <td>DIRECTORY/SUB-DIRECTORY</td> <td>_OUTLINE_</td> </tr> <tr> <td>MFG ENGG</td> <td></td> <td>SIZE</td> <td>CAGE CODE</td> <td>DRAWING NO.</td> <td></td> </tr> <tr> <td>ECO APPRV</td> <td>DNg 11.25.24</td> <td>C</td> <td>30990</td> <td>P676</td> <td>REV. F</td> </tr> </tbody> </table>	MATERIAL		SPECIFICATION		PROCUREMENT		APPROVAL INITIALS	DATE	Amphenol CDI 12900 Alondra Blvd. Cerritos, CA 90703		SHEET 1 OF 1		DRAWN BY	BRD 02/16/96	CHECKED BY		TEST ENGG		QUALITY		TITLE		SMP SHROUD, THREAD IN STYLE		DESIGN ENGG	ATV 07.05.00	SCALE	10/1	DIRECTORY/SUB-DIRECTORY	_OUTLINE_	MFG ENGG		SIZE	CAGE CODE	DRAWING NO.		ECO APPRV	DNg 11.25.24	C	30990	P676	REV. F
WORK STD	PROD INST	ASSY INST																																																	
NA	NA	NA																																																	
MATERIAL		SPECIFICATION		PROCUREMENT																																															
APPROVAL INITIALS	DATE	Amphenol CDI 12900 Alondra Blvd. Cerritos, CA 90703		SHEET 1 OF 1																																															
DRAWN BY	BRD 02/16/96																																																		
CHECKED BY																																																			
TEST ENGG																																																			
QUALITY		TITLE		SMP SHROUD, THREAD IN STYLE																																															
DESIGN ENGG	ATV 07.05.00	SCALE	10/1	DIRECTORY/SUB-DIRECTORY	_OUTLINE_																																														
MFG ENGG		SIZE	CAGE CODE	DRAWING NO.																																															
ECO APPRV	DNg 11.25.24	C	30990	P676	REV. F																																														